







\*\*\*\* GREAT OPPORTUNITY WITH PLENTY OF POTENTIAL \*\*\*\* Three bedroom semi detached property in a popular location offering a porch, lounge diner, kitchen, three bedrooms and a bathroom.. Good size drive and a single garage, rear garden.





## PORCH

Entrance door into the porch with door to -

## LOUNGE DINER

Patio doors to the rear, window to the front, radiator, stairs to the first floor and door to the kitchen.

## KITCHEN

Fitted units with work surface and sink and drainer unit, Storage cupboard window and door to the garden.

## FIRST FLOOR LANDING

Doors to -

## BEDROOM

Window and radiator.

## BEDROOM

Window and radiator.

## BEDROOM

Window and radiator.

## BATHROOM

Bath, low flush wc, wash hand basin, window and radiator.

## OUTSIDE

Drive and a single garage, side gated access to the rear garden with patio and lawn.







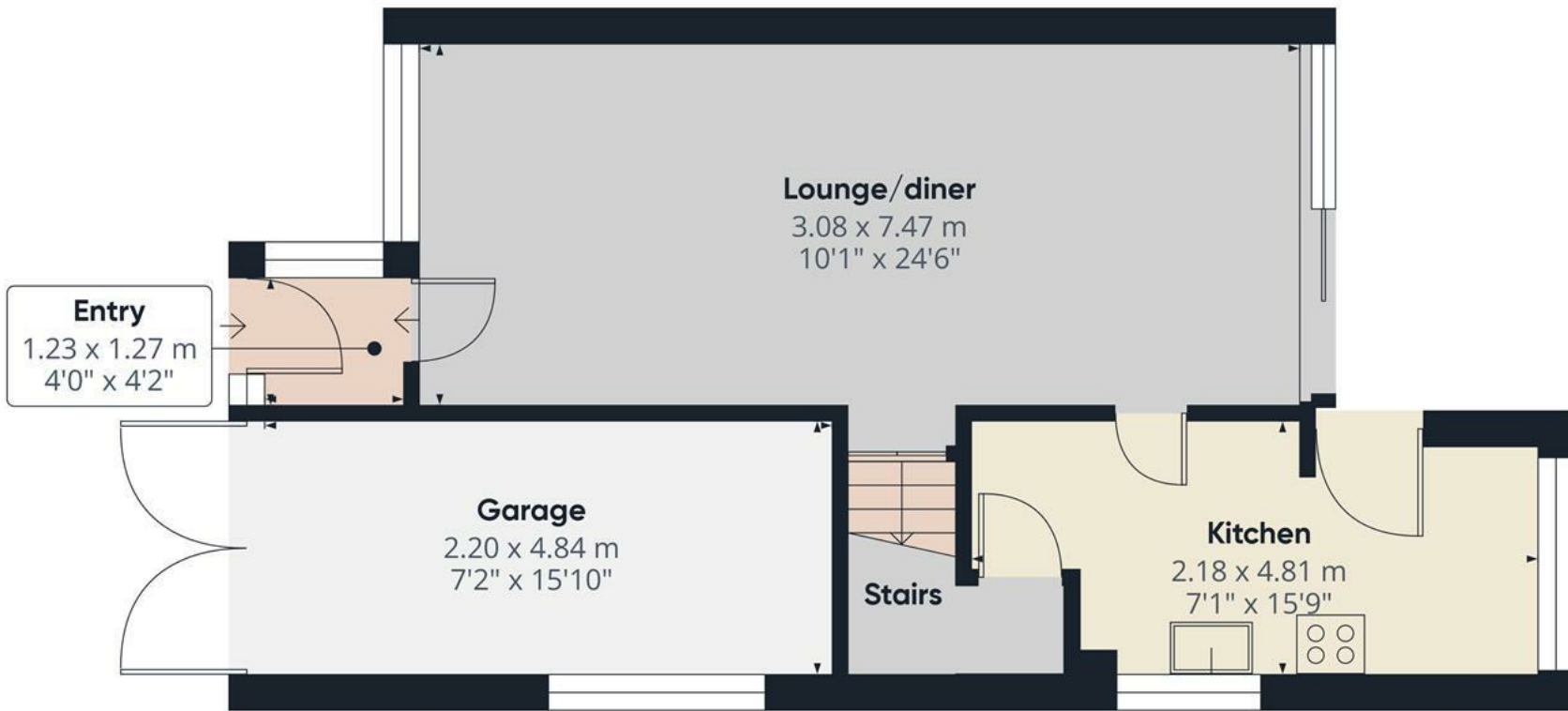

**Approximate total area<sup>(1)</sup>**  
47.56 m<sup>2</sup>  
511.93 ft<sup>2</sup>

(1) Excluding balconies and terraces.

While every attempt has been made to ensure accuracy, all measurements are approximate, not to scale. This floor plan is for illustrative purposes only.

Calculations were based on RICS IPMS 3C standard. Please note that calculations were adjusted by a third party and therefore may not comply with RICS IPMS 3C.

**GIRAFFE360**

Floor 0



Approximate total area<sup>(1)</sup>  
37.31 m<sup>2</sup>  
401.61 ft<sup>2</sup>

**Bathroom**  
2.17 x 1.91 m  
7'1" x 6'3"

(1) Excluding balconies and terraces.

While every attempt has been made to ensure accuracy, all measurements are approximate, not to scale. This floor plan is for illustrative purposes only.

Calculations were based on RICS IPMS 3C standard. Please note that calculations were adjusted by a third party and therefore may not comply with RICS IPMS 3C.

GIRAFFE360

Floor 1



