



## 87 Charles Street Cheadle, Stoke-On-Trent, ST10 1EE

Abode are delighted to offer for sale this two bedroom, mid terraced home, which is conveniently situated within close proximity to Cheadle Town Centre, its schools (rated good and outstanding), shops and amenities. Benefiting from a recently fitted boiler and new flooring in the kitchen and master bedroom, the property is situated just off Charles Street providing a quiet location.

The property is perfect for first time buyers, buy to let investors or even those looking for a holiday home.

In brief, the property comprises living room and kitchen to the ground floor, and two bedrooms and a shower room to the first floor.

Having a low maintenance front garden and being well presented throughout, an early viewing is highly recommended!

**£109,950**

## 87 Charles Street

Cheadle, Stoke-On-Trent, ST10 1EE



Living Room

Kitchen

Landing

Bedroom

Bedroom

Shower Room

Garden



Directions



Floor Plan

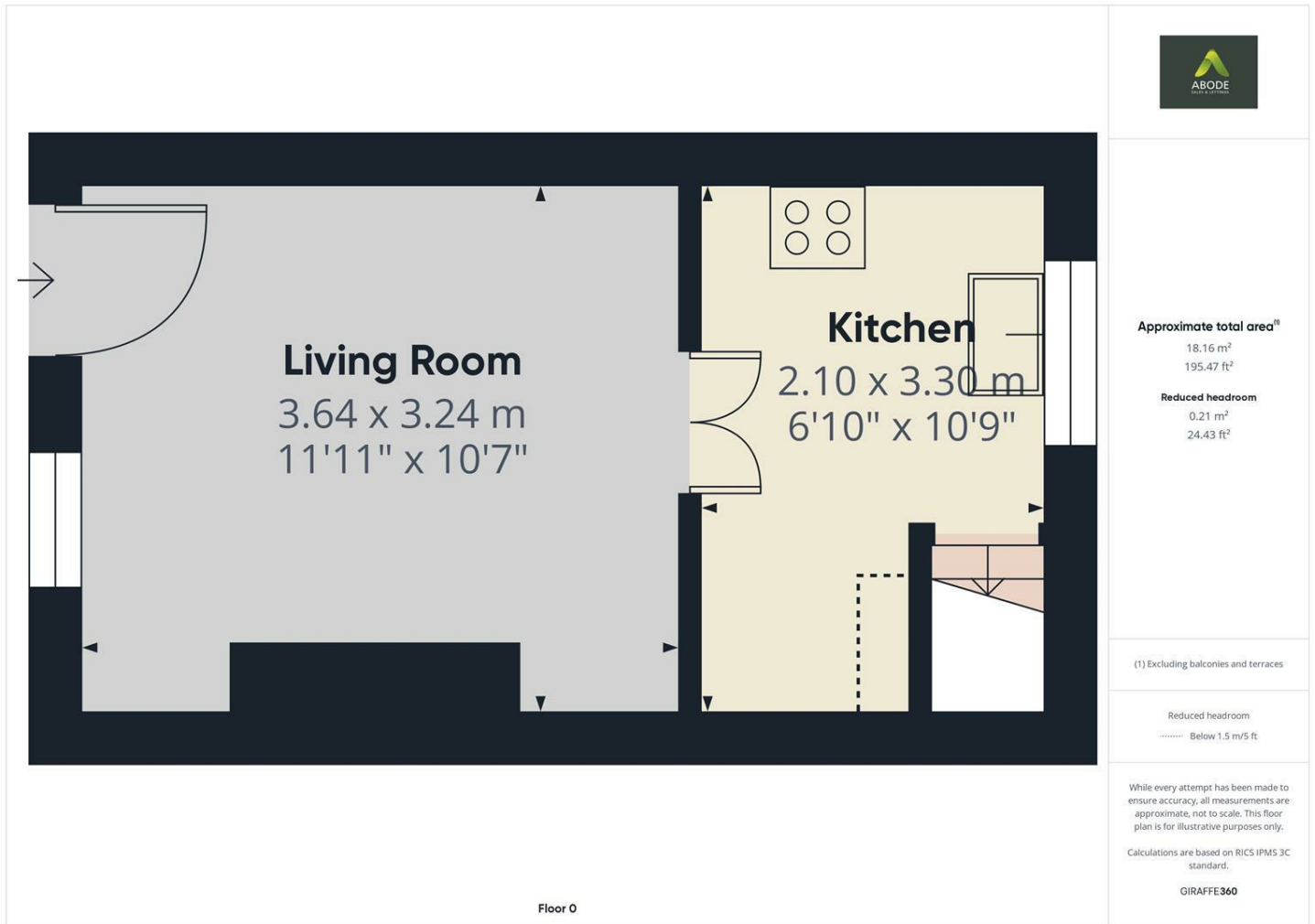

These particulars, whilst believed to be accurate are set out as a general outline only for guidance and do not constitute any part of an offer or contract. Intending purchasers should not rely on them as statements of representation of fact, but must satisfy themselves by inspection or otherwise as to their accuracy. No person in this firm's employment has the authority to make or give any representation or warranty in respect of the property.

1 Cross Street, Cheadle, Cheadle, ST10 1NP  
Tel: 01538 750081 Email: ashbourne@abodemidlands.co.uk <https://www.abodemidlands.co.uk>

