





Two-bedroom terraced cottage located in the sought-after historical village of Tutbury, Staffordshire.

Upon entering, you are greeted by a cosy lounge featuring a traditional log burner and beautiful wooden beams, creating a warm and inviting atmosphere perfect for relaxing evenings. The kitchen, utility area, and ground floor bathroom provide convenience and functionality, catering to all your daily needs.

One of the highlights of this property is the extensive rear garden, offering ample space for outdoor activities, gardening, or simply enjoying the fresh air in a private setting.

Situated in the heart of Tutbury, you'll have easy access to the village's rich history, quaint shops, and local amenities, making it a delightful place to call home.















Floor 0

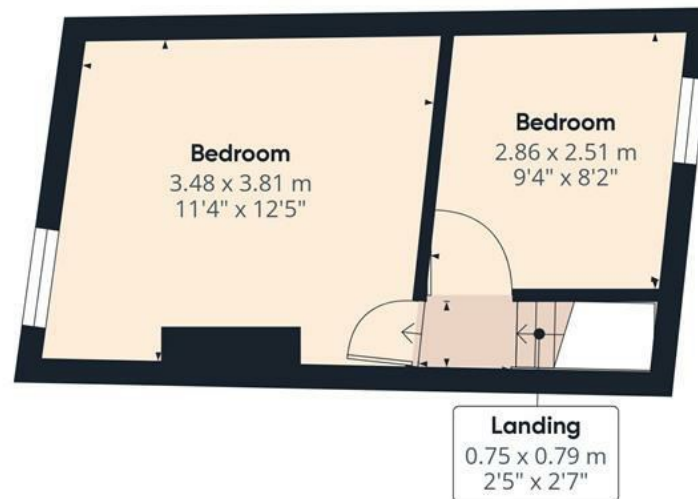

Floor 1

Approximate total area⁽¹⁾

54.83 m²

590.18 ft²

(1) Excluding balconies and terraces

While every attempt has been made to ensure accuracy, all measurements are approximate, not to scale. This floor plan is for illustrative purposes only.

Calculations are based on RICS IPMS 3C standard.

GIRAFFE360

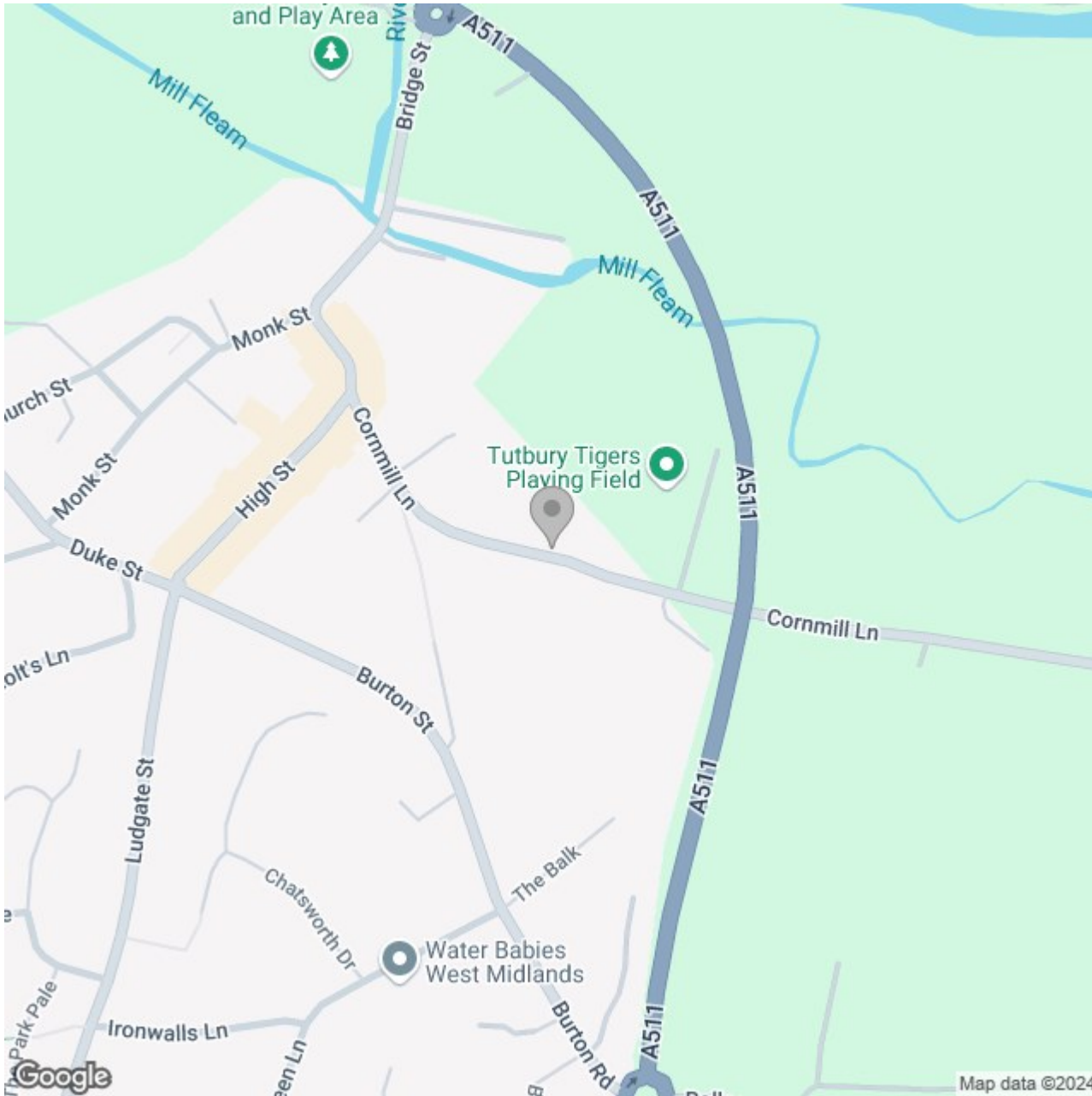

Energy Efficiency Rating

	Current	Potential
Very energy efficient - lower running costs		
(92 plus) A		
(81-91) B		
(69-80) C		
(55-68) D		
(39-54) E		
(21-38) F		
(1-20) G		
Not energy efficient - higher running costs		
England & Wales	EU Directive 2002/91/EC	