

Little Ithaca Shobnall Road, Burton-On-Trent, DE13 0QJ

£845 PCM





As you step into the house, you are greeted by a sleek, Porcelanosa-tiled heated floor that sets the tone for modern comfort. The open-plan layout seamlessly blends the lounge and kitchen areas, creating a bright and inviting space perfect for relaxation or entertaining. The kitchen comes fully equipped with high-quality white goods, adding both convenience and style.

A striking spiral staircase leads you to the upper level, where you'll find a spacious double bedroom featuring a generously sized built-in wardrobe. Adjacent to the bedroom is a luxurious bathroom, thoughtfully designed with premium fixtures, including a designer bathtub and a separate shower, offering the perfect sanctuary for unwinding at the end of the day.

Call ABODE Lettings to arrange your viewing!







Floor Plans

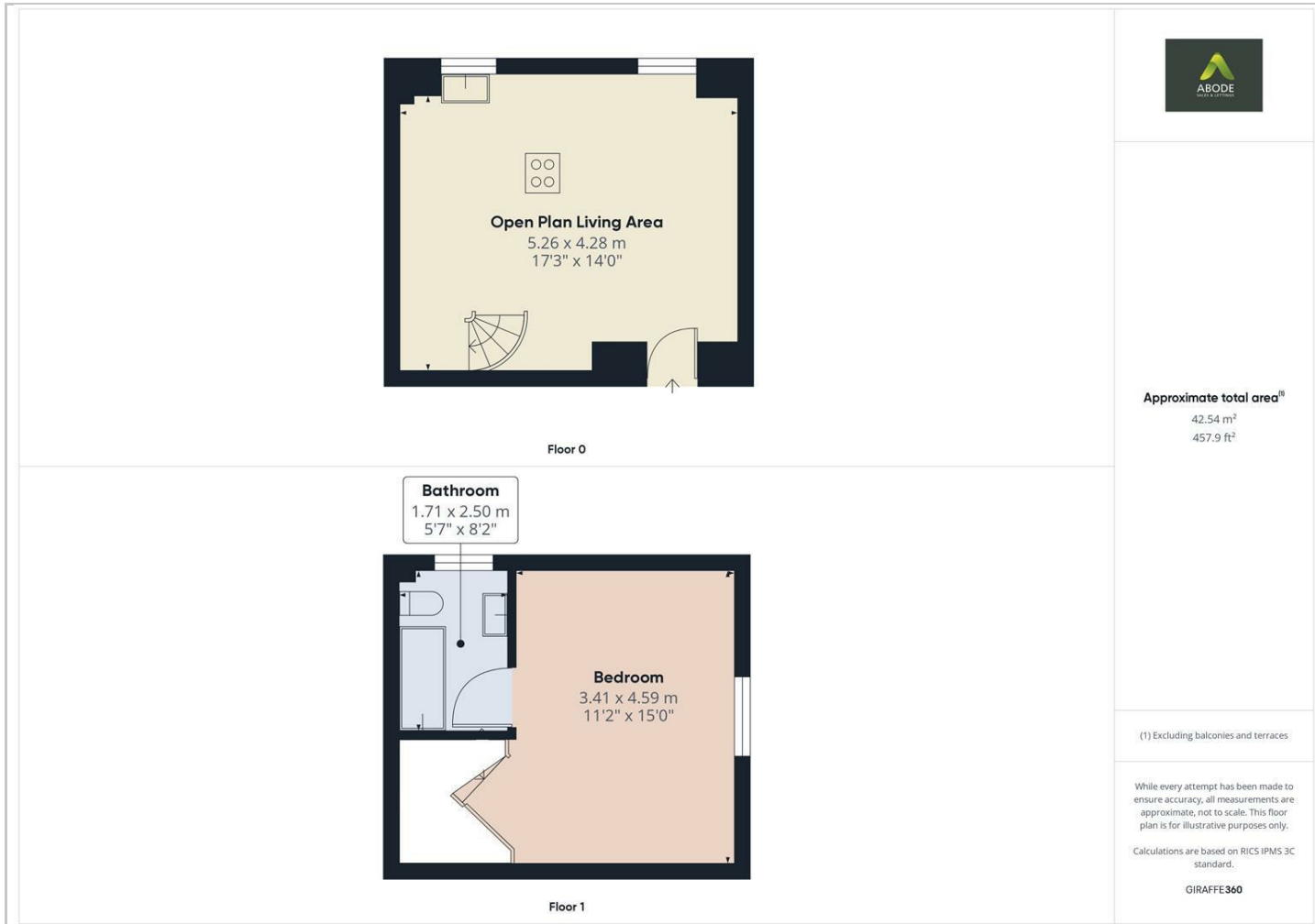

Location Map

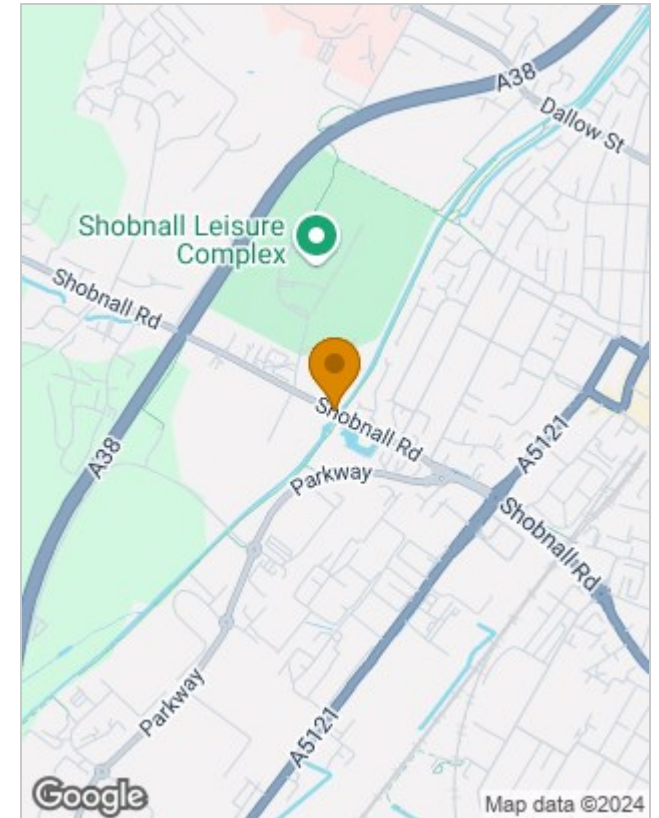

Energy Performance Graph

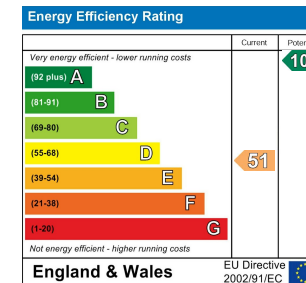

Please contact our Burton Lettings Office on 01283 845888 if you wish to arrange a viewing appointment for this property or require further information.

The particulars are set out as a general outline only for the guidance of intended purchasers or lessees, and do not constitute, any part of a contract. Nothing in these particulars shall be deemed to be a statement that the property is in good structural condition or otherwise nor that any of the services, appliances, equipment or facilities are in good working order. Purchasers should satisfy themselves of this prior to purchasing.