





**** IMMACULATE CONDITION
**** GOOD SIZE THREE
BEDROOM WITH EN SUITE
SHOWER ROOM AND
BATHROOM **** 2022 Bellway
built semi detached property
offering a hall, guest
cloakroom, fitted kitchen with
built in appliances, lounge diner
with doors onto the the garden.
Three first floor bedrooms,
master with en suite and a
family bathroom. Side drive for
2-3 vehicles, front garden and a
good size enclosed rear garden.
INTERNAL VIEWING IS HIGHLY
RECOMMENDED



HALL

Entrance door into the hall with radiator, stairs to the first floor and doors to -

CLOAKROOM

Low flush wc, wash hand basin, radiator and upvc double glazed window.

KITCHEN

Fitted wall mounted base and drawer units with work surfaces and a sink and drainer unit. Fitted electric oven with gas hob and extractor hood, integrated fridge freezer, dishwasher and washing machine. Radiator and upvc double glazed window.

LOUNGE

Two radiators, storage cupboard, upvc double glazed window and double doors onto the garden.

FIRST FLOOR LANDING

Loft access and doors to -

BEDROOM 1

Upvc double glazed window, radiator and door to the en suite.

EN SUITE

Enclosed shower, wash hand basin, low flush wc, radiator and upvc double glazed window.

BEDROOM 2

Upvc double glazed window and radiator.



BEDROOM 3

Upvc double glazed window and radiator.







BATHROOM

Panel enclosed bath, low flush wc, wash hand basin and radiator.

OUTSIDE

Front lawn with hedge boundary. Enclosed rear garden with paved patio and a lawn with some borders.
Side long drive providing parking for 2-3 vehicles.





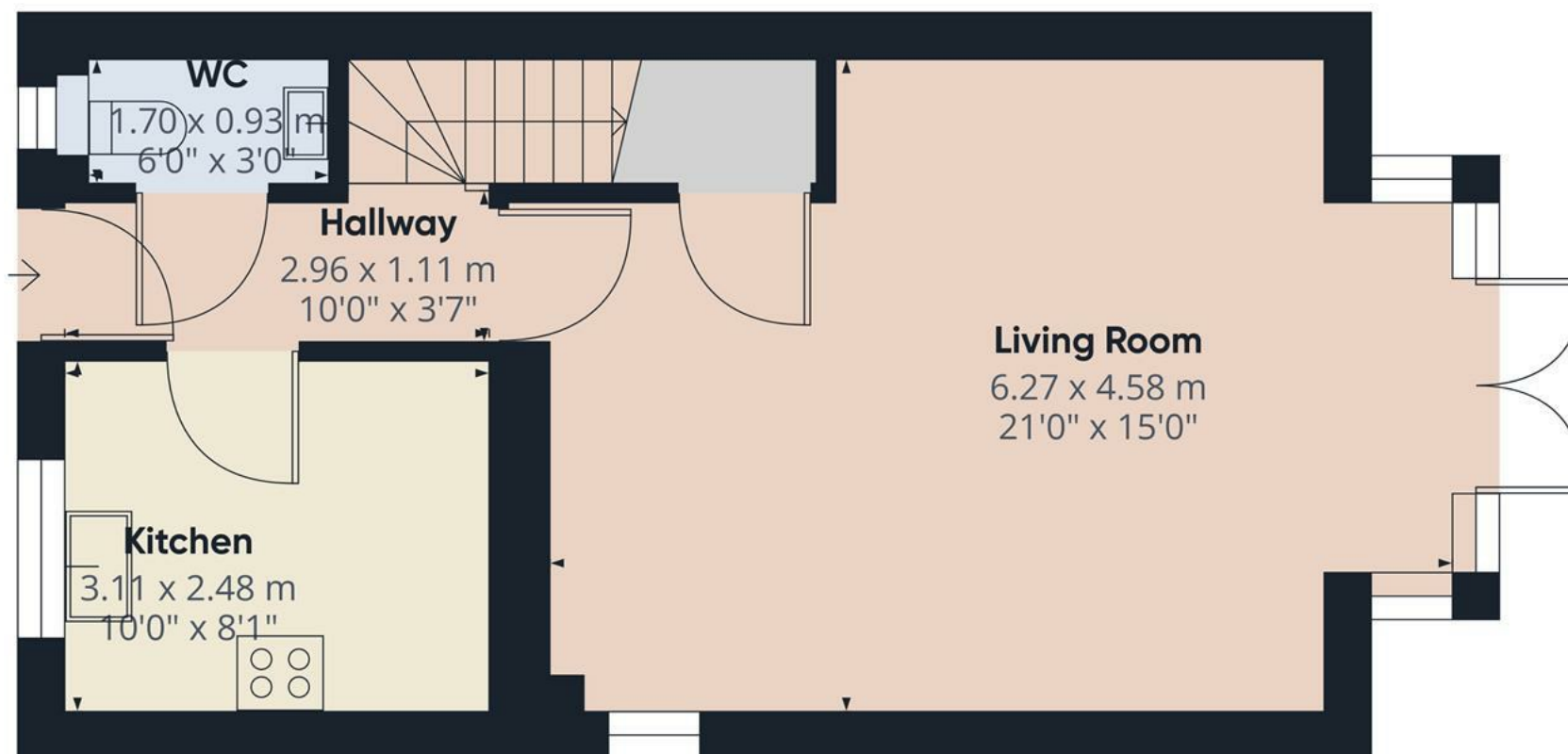

Approximate total area⁽¹⁾

41.78 m²

449.72 ft²

(1) Excluding balconies and terraces

While every attempt has been made to ensure accuracy, all measurements are approximate, not to scale. This floor plan is for illustrative purposes only.

GIRAFFE360

Floor 0

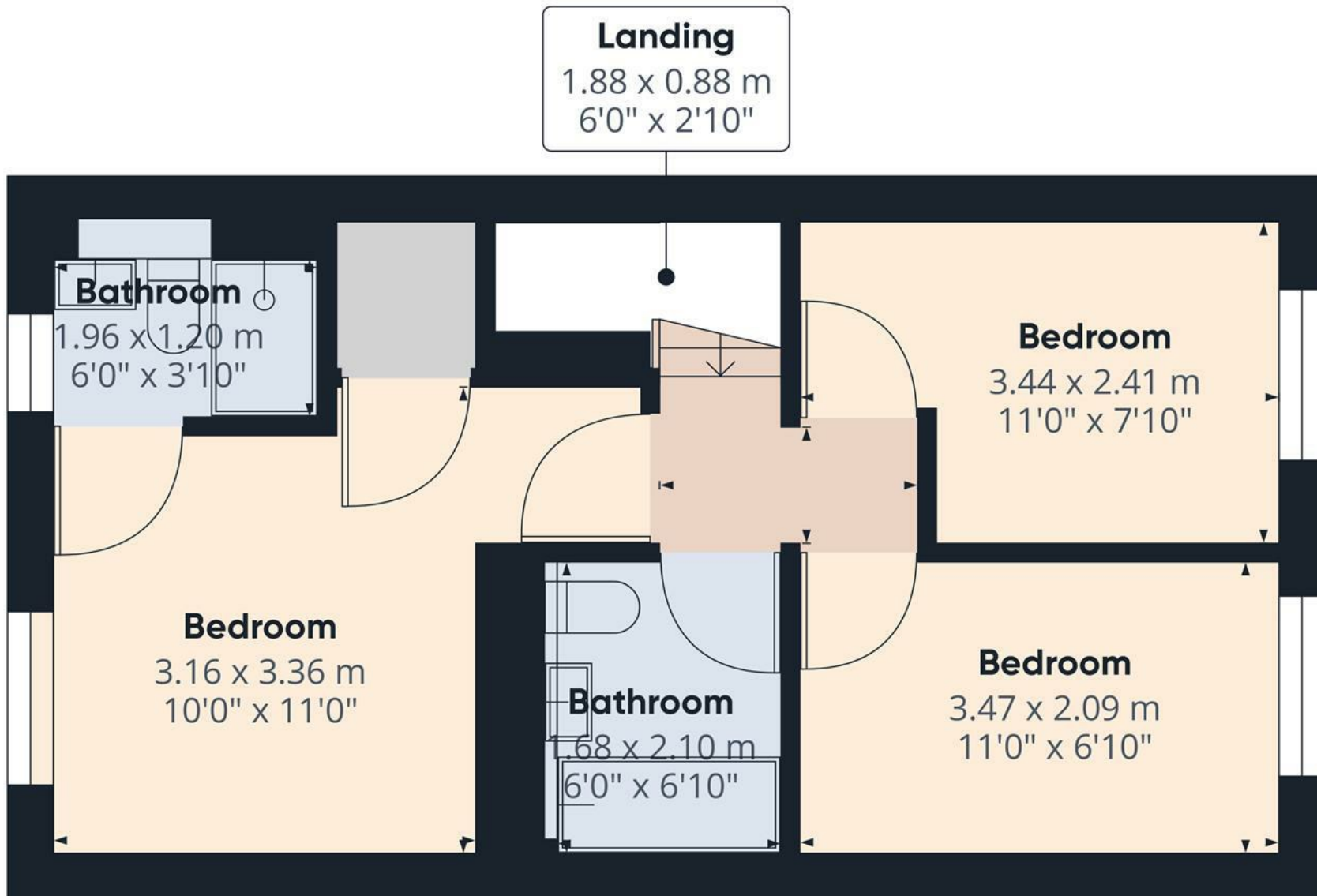

Approximate total area⁽¹⁾
35.73 m²
384.59 ft²

(1) Excluding balconies and terraces

While every attempt has been made to ensure accuracy, all measurements are approximate, not to scale. This floor plan is for illustrative purposes only.

GIRAFFE360

Floor 1

