

10 Boswell Court, Ashbourne, DE6 1SA

£795 PCM

 **ABODE**  
SALES & LETTINGS



 **ABODE**  
SALES & LETTINGS







ABODE Lettings are pleased to offer for rental this well presented three bedroom townhouse situated at Ashbourne on the edge of the peak district. Available July 2024.

To the ground floor there is an entrance hallway, garage which is also used as a utility area which benefits from appliances. There is also a small office.

To the first floor there is a fitted kitchen with breakfast bar and a selection of Neff appliances. Living room with bay window and feature fireplace.

The second floor provides two bedrooms, the master with built in large wardrobes and feature bay window. The second bedroom also has a small wardrobe/cupboard. Shower Room with oversized shower.

Outside there is a courtyard which could also be used as a driveway for a small vehicle and provides access to the garage

Call ABODE Lettings to book your viewing!











## Floor Plans

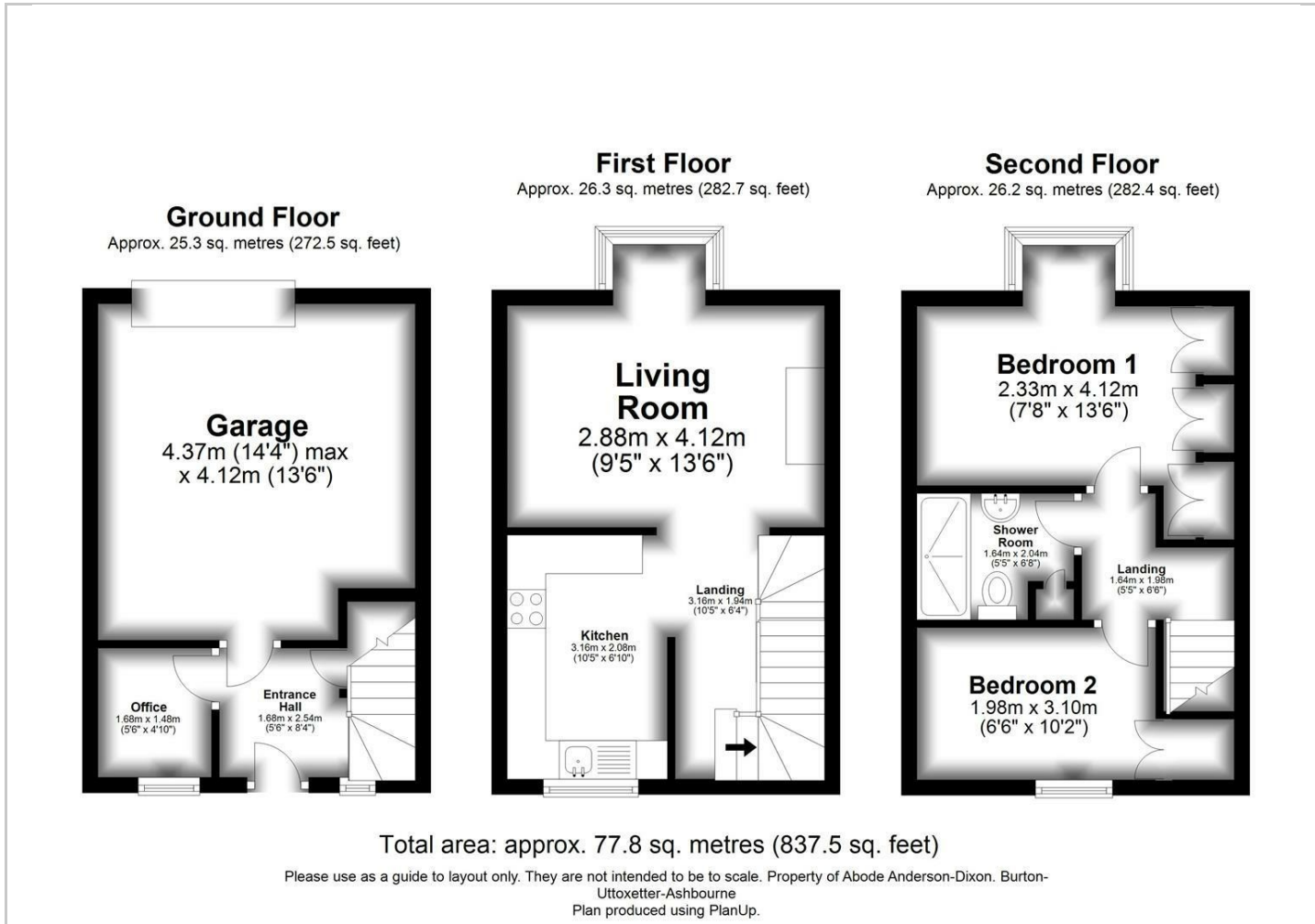

## Location Map

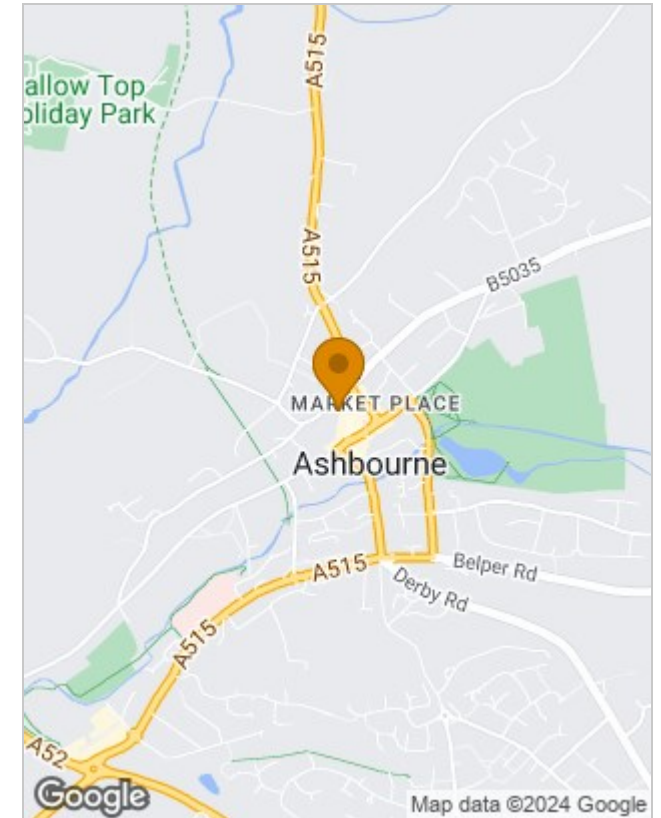

## Energy Performance Graph

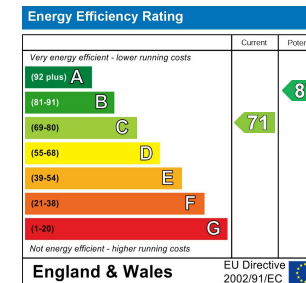

Please contact our Burton Lettings Office on 01283 845888 if you wish to arrange a viewing appointment for this property or require further information.

The particulars are set out as a general outline only for the guidance of intended purchasers or lessees, and do not constitute, any part of a contract. Nothing in these particulars shall be deemed to be a statement that the property is in good structural condition or otherwise nor that any of the services, appliances, equipment or facilities are in good working order. Purchasers should satisfy themselves of this prior to purchasing.