





****360 VIRTUAL TOUR** **EN-SUITE SHOWER ROOM** **REMAINING BUILDERS WARRANTY**** A beautifully presented two bedroom home, situated within a popular development having walking distance from John Taylor free school. The property benefits from having two double bedrooms, with the master having an en-suite shower room, generous lounge diner and a driveway providing ample parking facility. Viewing is highly recommended strictly via appointment only.













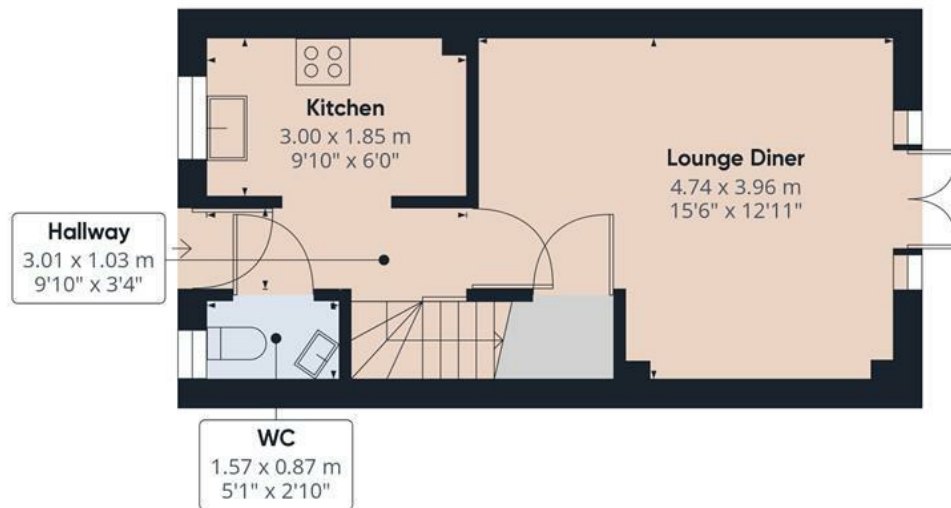

Floor 0



Floor 1

Approximate total area⁽¹⁾

57.44 m²

618.28 ft²

(1) Excluding balconies and terraces

While every attempt has been made to ensure accuracy, all measurements are approximate, not to scale. This floor plan is for illustrative purposes only.

GIRAFFE360

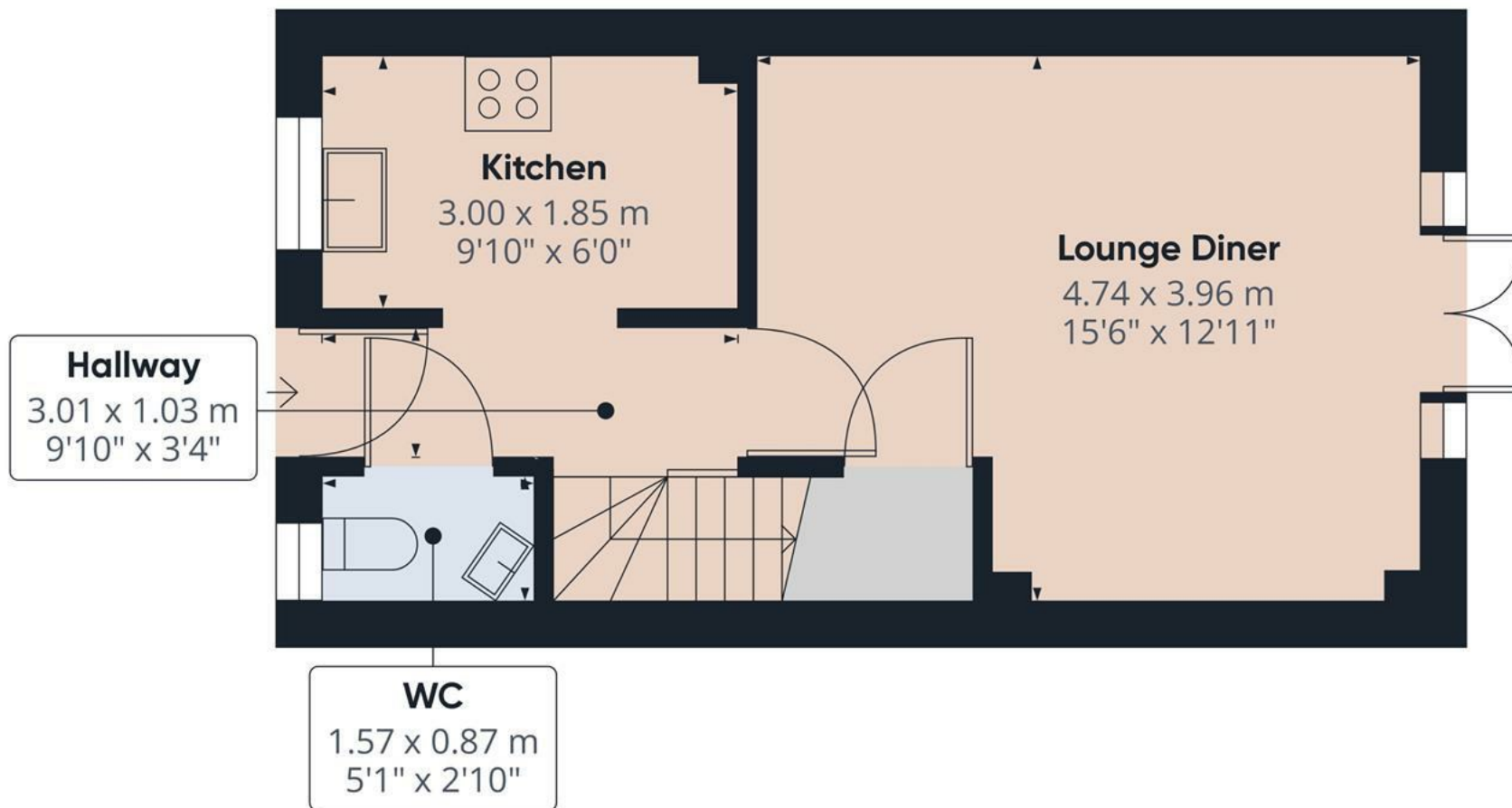

Approximate total area⁽¹⁾
30.54 m²
328.68 ft²

(1) Excluding balconies and terraces

While every attempt has been made to ensure accuracy, all measurements are approximate, not to scale. This floor plan is for illustrative purposes only.

GIRAFFE360

Floor 0

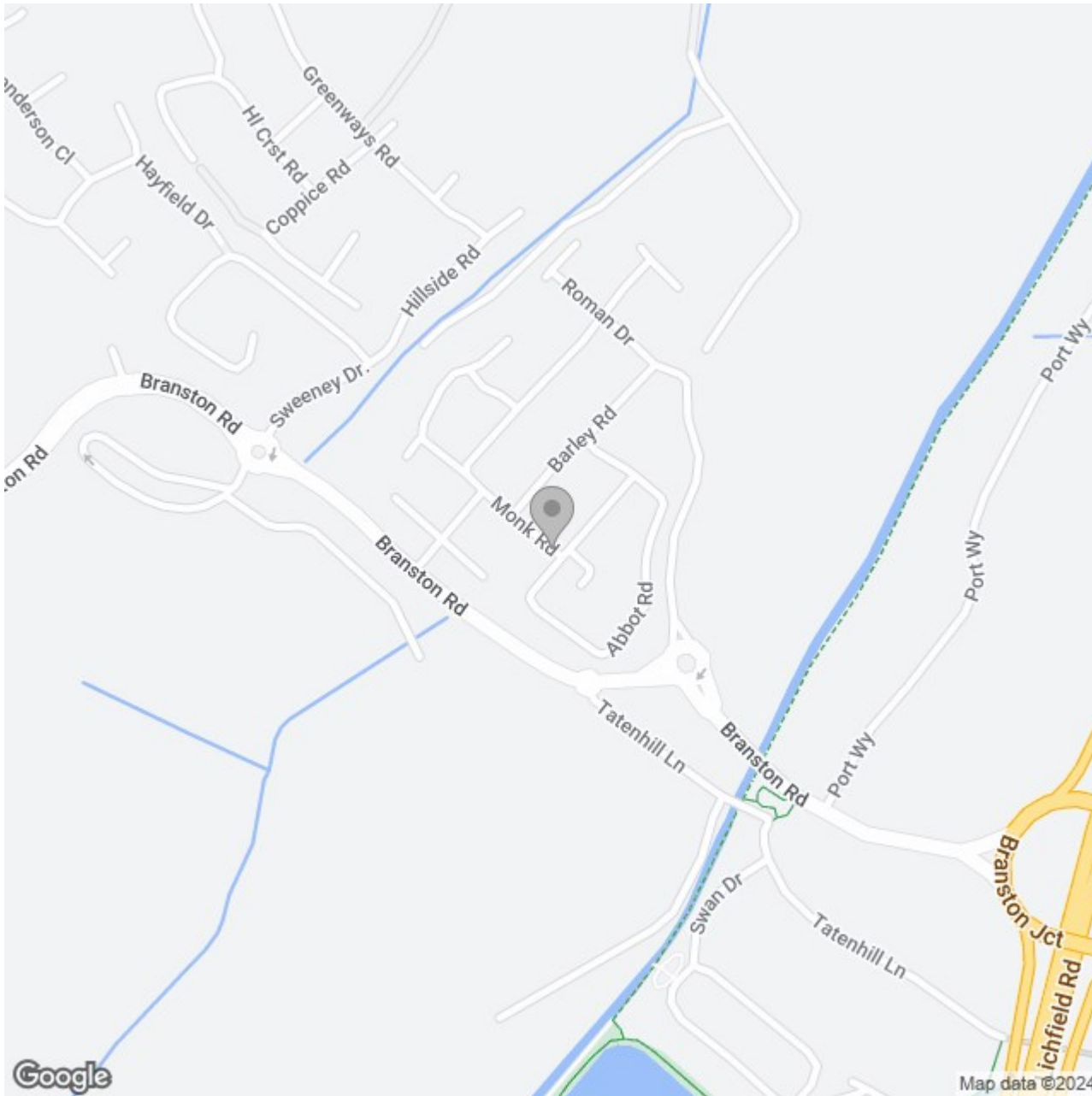

Energy Efficiency Rating

	Current	Potential
Very energy efficient - lower running costs		
(92 plus) A		98
(81-91) B	84	
(69-80) C		
(55-68) D		
(39-54) E		
(21-38) F		
(1-20) G		
Not energy efficient - higher running costs		
England & Wales	EU Directive 2002/91/EC	